

N.C. HIGHWAY 73 SIDEWALK IMPROVEMENTS TO SERVE TOWN OF MOUNT GILEAD MONTGOMERY COUNTY, NORTH CAROLINA

INDEX OF SHEETS	
SHEET NO.	TITLE
1	COVER SHEET
L-1	OVERALL SIDEWALK PLAN
L-2	SIDEWALK PLAN
L-3	SIDEWALK PLAN
L-4	DETAILS
L-5	DETAILS
L-6	DETAILS
L-7	DETAILS
L-8	DETAILS

- | | | |
|--------------|---|-----------------|
| Mayor | - | Earl Poplin |
| Commissioner | - | Tim McAuley |
| Commissioner | - | Paula Covington |
| Commissioner | - | Branson Webb |
| Commissioner | - | Vera Richardson |
| Town Manager | - | Katrina Tatum |

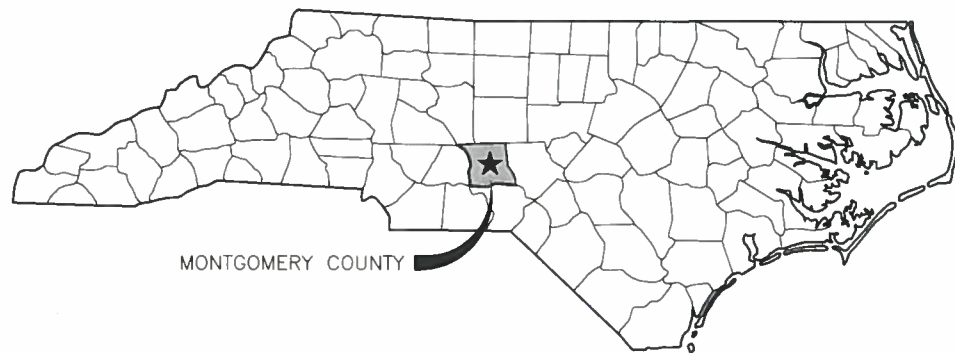

MONTGOMERY COUNTY

COUNTY LOCATION MAP
NTS

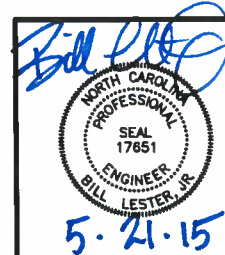

LKC

*Engineering
Landscape Architecture
Planning*

LKC Engineering, pllc
140 Aqua Shed Court
Aberdeen, NC 28315
O: 910.420.1437
F: 910.637.0096
lkceengineering.com
License No. P-1095

L:\MCD-14.01 - NC 73 Sidewalk Project\B00 Drawings\B10 Design Drawings\100%CD.dwg - Last Saved By: ANDY PATTERSON, 5/22/2015 10:43:32 AM, L-1 Site Plan, Plotted By: Andy Patterson, 05/22/15 10:48:35 AM
 XREF: MCD1401-001b.dwg; L:\MCD-14.01 - NC 73 Sidewalk Project\B00 Drawings\B10 Design Drawings\B10 Design Drawings\DETAIL\100%CD.dwg

REVISIONS			
SYM.	DESCRIPTION	DATE	BY
	REVISED PER NCDOT COMMENTS	3-31-15	WLS



LKC Engineering, PLLC
 140 Aqua Shed Court
 Aberdeen, NC 28315
 O: 910.420.1437
 F: 910.637.0096
 lkceengineering.com
 License No. P-1095

Engineering
 Landscape Architecture
 Planning

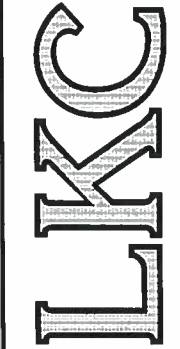

OVERALL SIDEWALK
 PLAN

NC HIGHWAY 73
 SIDEWALK IMPROVEMENTS
 TO SERVE
 TOWN OF MOUNT GILEAD
 MONTGOMERY COUNTY, NORTH CAROLINA

DATE: MAY, 2015
DESIGNED: WLS
DRAWN: WLS
CHECKED: -
NO.

L-1

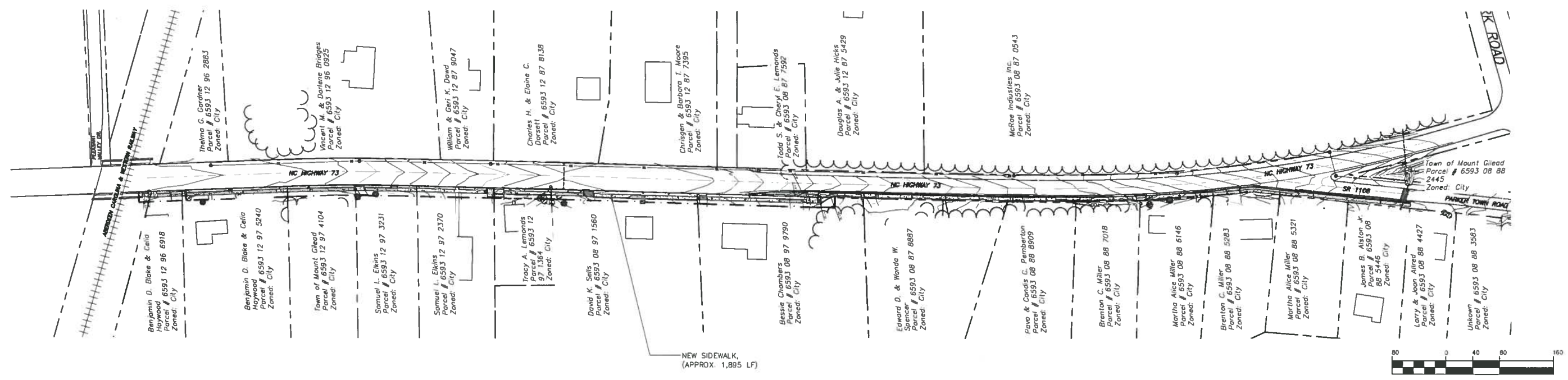

1 SIDEWALK OVERALL SITE PLAN
 SCALE: 1" = 80'-0"

GENERAL CONSTRUCTION NOTES.

1. THE CONTRACTOR SHALL CONTACT ALL APPLICABLE UTILITY COMPANIES FOR THE EXACT LOCATION OF ALL UNDERGROUND MAINS, CABLES, OR LINES BEFORE CONSTRUCTION BEGINS.
2. ALL WORK PERFORMED WITHIN NORTH CAROLINA DEPARTMENT OF TRANSPORTATION RIGHTS-OF-WAY SHALL BE PERFORMED IN STRICT ACCORDANCE WITH THE NCDOT CONSTRUCTION AND MAINTENANCE OPERATIONS SUPPLEMENT TO THE MANUAL ON UNIFORM TRAFFIC CONTROL DEVICES. THE CONTRACTOR SHALL BE RESPONSIBLE FOR PERFORMING THE WORK AND ADHERING TO THE RIGHT-OF-WAY ENCROACHMENT CONTRACT SPECIAL PROVISIONS.
3. ALL SIDEWALKS AND HANDICAP RAMPS TO BE BUILT IN ACCORDANCE WITH THE CURRENT EDITION OF THE NCDOT STANDARD SPECIFICATIONS FOR ROADS AND STRUCTURES AND THE ROADWAY STANDARD DRAWINGS MANUAL.
4. AS WELL AS THE NCDOT REQUIREMENTS, ALL SIDEWALKS AND HANDICAP RAMPS TO MEET THE REQUIREMENTS OF THE AMERICANS WITH DISABILITIES ACT (ADA).
5. ALL CROSSWALK STRIPING, IF REQUIRED, TO BE IN ACCORDANCE WITH THE CURRENT EDITION OF THE NCDOT ROADWAY STANDARD DRAWING # 848.05 AND THE CURRENT EDITION OF THE MANUAL ON UNIFORM TRAFFIC CONTROL DEVICES (MUTCD). CROSSWALK MARKINGS TO BE 6 INCH SOLID WHITE LINES AND NOT LESS THAN 6 FEET WIDE.
6. ALL SIDEWALKS TO BE CLASS "B" CONCRETE WITH SIDEWALK FINISH.
7. ALL SIDEWALKS TO BE A MINIMUM OF 4 INCHES THICK AND 5 FEET WIDE, EXCEPT AT NOTED DRIVEWAYS WHERE THEY ARE TO BE A MINIMUM OF 6 INCHES THICK.
8. ALL SIDEWALKS ENDING AT A HANDICAP RAMP SHALL END A MINIMUM OF 3 FEET PAST HANDICAP RAMP TAPER.
9. ALL SIDEWALK SUBGRADE TO BE COMPACTED TO 95% PROCTOR AND TO BE FREE OF ANY ROOTS AND DEBRIS FOR AT LEAST 6 INCHES DEPTH.
10. ALL LANDSCAPING TO BE UNDISTURBED. IF LANDSCAPE MUST BE DISTURBED IT SHALL BE REPLACED AS SOON AS DISTURBANCE IS COMPLETED IN THAT AREA.
11. TRAFFIC BOXES, DROP INLET COVERS, SIGNALIZATION BOXES AND WATER VALVES IN SIDEWALK AREA TO REMAIN AND CONTRACTOR TO BRING THEM UP TO SIDEWALK GRADE.
12. ALL ROAD / STREET SIGNS IN SIDEWALK AREA TO BE RELOCATED BY THE NCDOT. CONTRACTOR TO COORDINATE RELOCATION SCHEDULE WITH THE NCDOT.
13. THE CONTRACTOR IS RESPONSIBLE FOR REPLACING ALL CURB AND GUTTER THAT IS BROKEN / DAMAGED IN THE PROJECT AREA. A MINIMUM OF 4 FEET IS TO BE CUT OUT AND REPLACED AT THESE LOCATIONS. (THESE ARE IN ADDITION TO AREAS NOTED FOR REPLACEMENT / ADJUSTMENT ON THE PLANS.)
14. ALL SIDEWALKS TO HAVE A MAXIMUM 2% CROSS SLOPE, UNLESS OTHERWISE NOTED.
15. CONTRACTOR TO TIE EXISTING GRADE TO SIDEWALK, NOT TO EXCEED 8% OVER 5 FEET UNLESS OTHERWISE SPECIFIED ON CROSS SECTIONS.
16. CONTRACTOR TO TIE TO EXISTING ASPHALT AND CONCRETE TO SIDEWALK, NOT TO EXCEED 8% OVER 5 FEET UNLESS SPECIFIED ON CROSS SECTIONS OR AS NOTED ON PLAN.
17. CONTRACTOR SHALL ADJUST ELEVATIONS OF ALL EXISTING VALVE BOXES AND TRAFFIC SIGNAL BOXES PROPOSED UNDER SIDEWALK. WHERE EXISTING ABOVE GRADE CONCRETE DRAINAGE STRUCTURES EXIST WITHIN PROPOSED SIDEWALK AREAS, CONTRACTOR SHALL CONSTRUCT NEW SIDEWALK TO MATCH EXISTING SLAB STRUCTURE ELEVATIONS AND INSTALL EXPANSION JOINTS IN ACCORDANCE WITH NCDOT STANDARD DETAIL 848.01 ON SHEET B.
18. CONTRACTOR SHALL REMOVE ALL EXISTING NC DOT SIGNAGE WITHIN DISTURBED AREAS FOR CONSTRUCTION OF SIDEWALK. SIGNAGE SHALL BE SET ASIDE AND PROTECTED FOR NC DOT TO REINSTALL AT THE CONCLUSION OF THE PROJECT. CONTRACTOR SHALL BE RESPONSIBLE FOR ANY DAMAGE CREATED TO SIGNAGE DURING REMOVAL AND CONSTRUCTION.
19. ALL LANE CLOSURE TIMES SHALL BE COORDINATED WITH NC DOT AND MAY BE PROHIBITED DURING HIGH VOLUME PERIODS AS ESTABLISHED BY NC DOT.
20. A CERTIFIED TESTING AGENCY SHALL BE PROVIDED BY OWNER FOR TESTING OF CONCRETE AS REQUIRED BY NC DOT SPECIFICATIONS. CONTRACTOR SHALL COORDINATE WITH TESTING AGENCY TO PROVIDE SAMPLES AS REQUIRED.

2 GENERAL NOTES

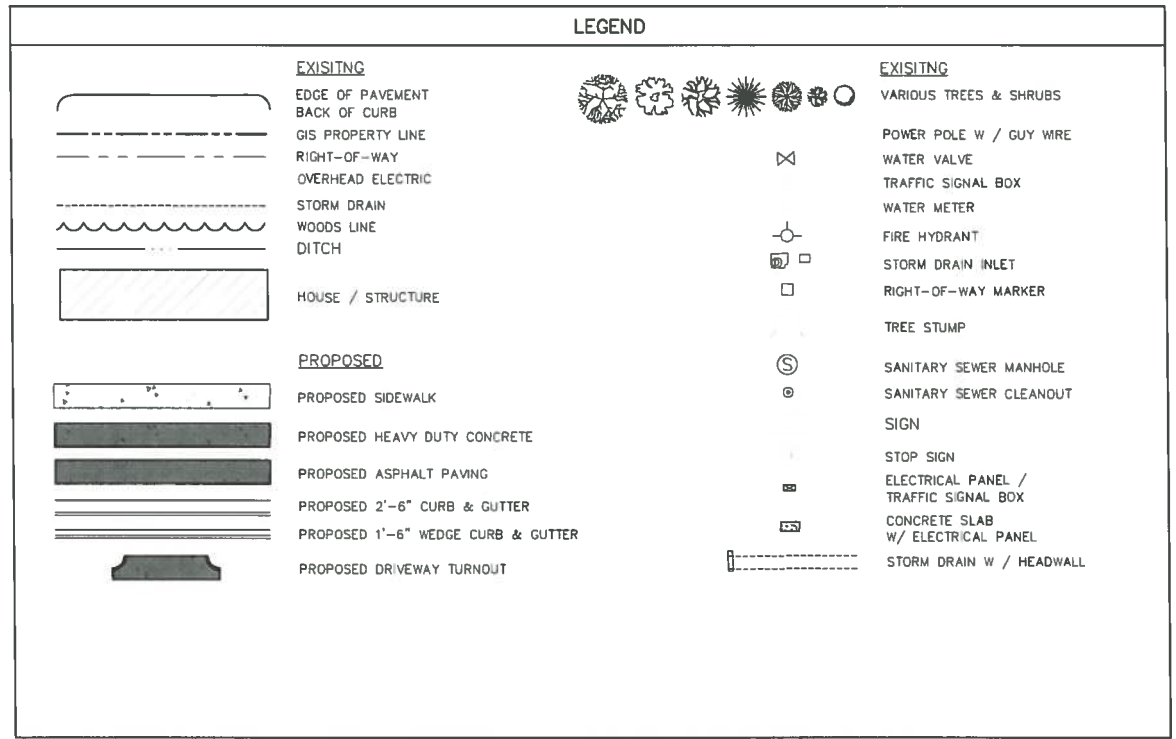

NOTE: LOCATIONS OF EXISTING UTILITIES AS SHOWN ARE APPROXIMATE ONLY. EXACT LOCATIONS ARE TO BE VERIFIED IN THE FIELD BY THE CONTRACTOR.



REVISIONS			
SYM.	DESCRIPTION	DATE	BY
REVIS	PER NCDOT COMMENTS	3-31-15	WLS

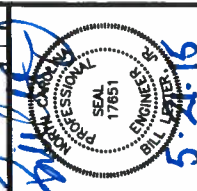

LKC Engineering, PLLC
 140 Aqua Shed Court
 Aberdeen, NC 28315
 O: 910.420.1437
 F: 910.637.0096
 lkceengineering.com
 License No. P-1095

Engineering
 Landscape Architecture
 Planning

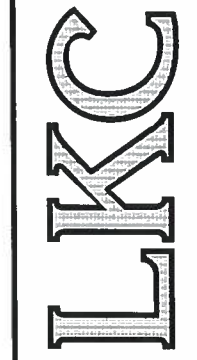

SIDEWALK PLAN

NC HIGHWAY 73
 SIDEWALK IMPROVEMENTS
 TO SERVE
 TOWN OF MOUNT GILEAD
 MONTGOMERY COUNTY, NORTH CAROLINA

DATE: MAY, 2015
 DESIGNED: WLS
 DRAWN: WLS
 CHECKED: -
 NO.

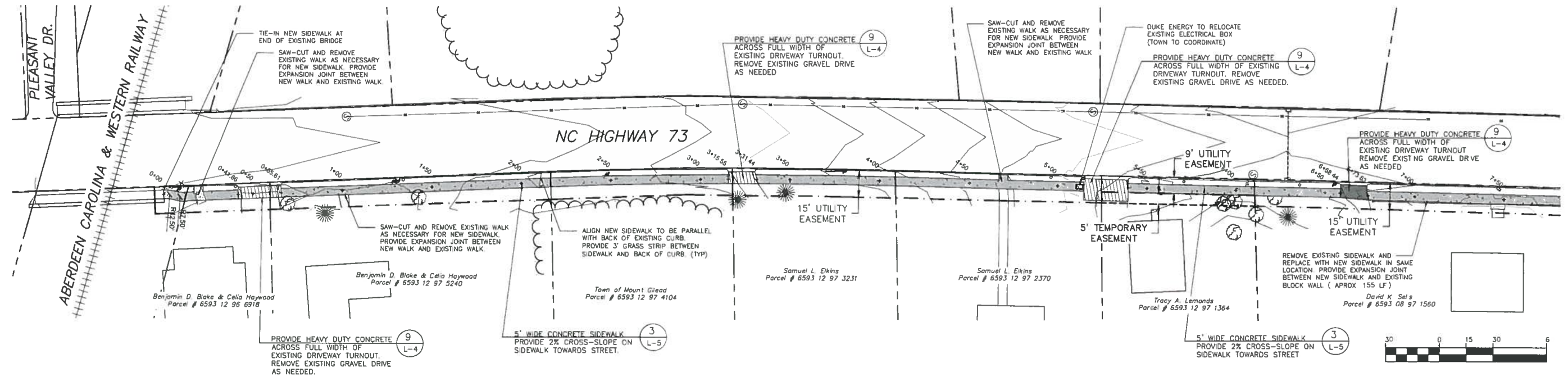

1 SIDEWALK LAYOUT PLAN (STA. 0+00 TO STA. 7+50)
 SCALE: 1" = 30'-0"

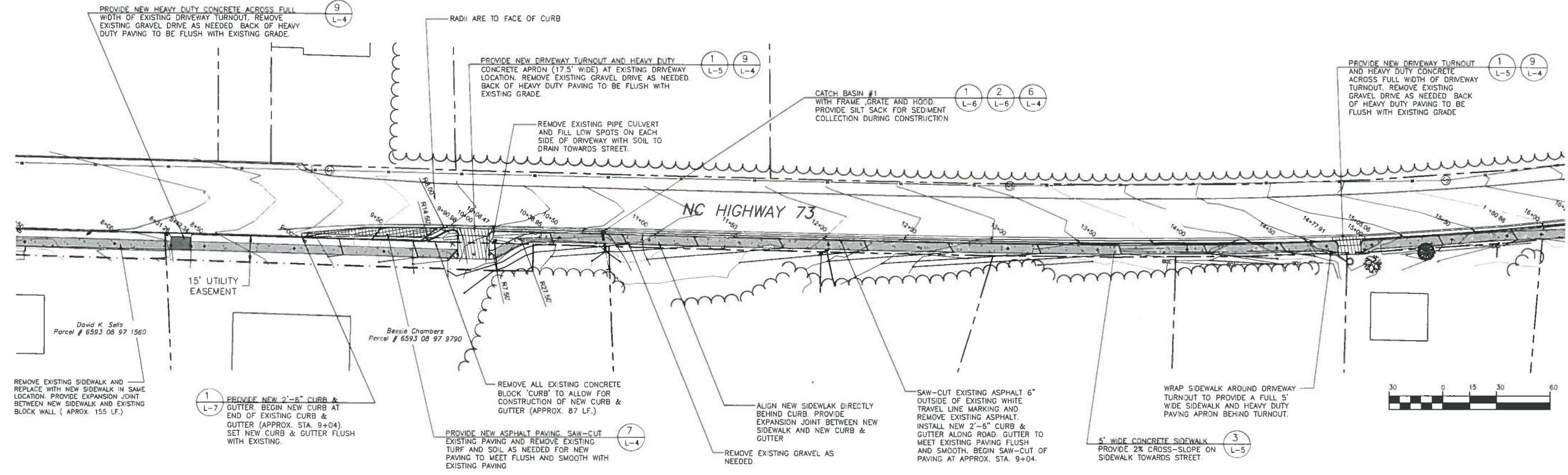

2 SIDEWALK LAYOUT PLAN (STA. 7+50 TO STA. 16+00)
 SCALE: 1" = 30'-0"

NOTE: LOCATIONS OF EXISTING UTILITIES AS SHOWN ARE APPROXIMATE ONLY. EXACT LOCATIONS ARE TO BE VERIFIED IN THE FIELD BY THE CONTRACTOR.



BEFORE YOU DIG!
 CALL 1-800-632-4848
 NC ONE CALL CENTER
 IT'S THE LAW!

L:\MIG-14.01 - NC 73 Sidewalk Project\800 Drawings\810 Design Drawings\1005CD.dwg: Last Saved By: ANDY PATTERSON, 5/22/2015, 10:51:49 AM, L-2 Layout, Plotted By: Andy Patterson, 05/22/15, 11:21:46 AM
 XREFS: MIG1401-g01tbl01.dwg, MIG1401-g01tbl02.dwg, MIG1401-g01tbl03.dwg, MIG1401-g01tbl04.dwg, MIG1401-g01tbl05.dwg, MIG1401-g01tbl06.dwg, MIG1401-g01tbl07.dwg, MIG1401-g01tbl08.dwg, MIG1401-g01tbl09.dwg, MIG1401-g01tbl10.dwg, MIG1401-g01tbl11.dwg, MIG1401-g01tbl12.dwg, MIG1401-g01tbl13.dwg, MIG1401-g01tbl14.dwg, MIG1401-g01tbl15.dwg, MIG1401-g01tbl16.dwg, MIG1401-g01tbl17.dwg, MIG1401-g01tbl18.dwg, MIG1401-g01tbl19.dwg, MIG1401-g01tbl20.dwg, MIG1401-g01tbl21.dwg, MIG1401-g01tbl22.dwg, MIG1401-g01tbl23.dwg, MIG1401-g01tbl24.dwg, MIG1401-g01tbl25.dwg, MIG1401-g01tbl26.dwg, MIG1401-g01tbl27.dwg, MIG1401-g01tbl28.dwg, MIG1401-g01tbl29.dwg, MIG1401-g01tbl30.dwg, MIG1401-g01tbl31.dwg, MIG1401-g01tbl32.dwg, MIG1401-g01tbl33.dwg, MIG1401-g01tbl34.dwg, MIG1401-g01tbl35.dwg, MIG1401-g01tbl36.dwg, MIG1401-g01tbl37.dwg, MIG1401-g01tbl38.dwg, MIG1401-g01tbl39.dwg, MIG1401-g01tbl40.dwg, MIG1401-g01tbl41.dwg, MIG1401-g01tbl42.dwg, MIG1401-g01tbl43.dwg, MIG1401-g01tbl44.dwg, MIG1401-g01tbl45.dwg, MIG1401-g01tbl46.dwg, MIG1401-g01tbl47.dwg, MIG1401-g01tbl48.dwg, MIG1401-g01tbl49.dwg, MIG1401-g01tbl50.dwg, MIG1401-g01tbl51.dwg, MIG1401-g01tbl52.dwg, MIG1401-g01tbl53.dwg, MIG1401-g01tbl54.dwg, MIG1401-g01tbl55.dwg, MIG1401-g01tbl56.dwg, MIG1401-g01tbl57.dwg, MIG1401-g01tbl58.dwg, MIG1401-g01tbl59.dwg, MIG1401-g01tbl60.dwg, MIG1401-g01tbl61.dwg, MIG1401-g01tbl62.dwg, MIG1401-g01tbl63.dwg, MIG1401-g01tbl64.dwg, MIG1401-g01tbl65.dwg, MIG1401-g01tbl66.dwg, MIG1401-g01tbl67.dwg, MIG1401-g01tbl68.dwg, MIG1401-g01tbl69.dwg, MIG1401-g01tbl70.dwg, MIG1401-g01tbl71.dwg, MIG1401-g01tbl72.dwg, MIG1401-g01tbl73.dwg, MIG1401-g01tbl74.dwg, MIG1401-g01tbl75.dwg, MIG1401-g01tbl76.dwg, MIG1401-g01tbl77.dwg, MIG1401-g01tbl78.dwg, MIG1401-g01tbl79.dwg, MIG1401-g01tbl80.dwg, MIG1401-g01tbl81.dwg, MIG1401-g01tbl82.dwg, MIG1401-g01tbl83.dwg, MIG1401-g01tbl84.dwg, MIG1401-g01tbl85.dwg, MIG1401-g01tbl86.dwg, MIG1401-g01tbl87.dwg, MIG1401-g01tbl88.dwg, MIG1401-g01tbl89.dwg, MIG1401-g01tbl90.dwg, MIG1401-g01tbl91.dwg, MIG1401-g01tbl92.dwg, MIG1401-g01tbl93.dwg, MIG1401-g01tbl94.dwg, MIG1401-g01tbl95.dwg, MIG1401-g01tbl96.dwg, MIG1401-g01tbl97.dwg, MIG1401-g01tbl98.dwg, MIG1401-g01tbl99.dwg, MIG1401-g01tbl100.dwg

L:\MCD-14.01 - NC 73 Sidewalk Project\800 Drawings\810 Design Drawings\100%CD.dwg, Last Saved By: ANDY PATTERSON, 5/22/2015 10:43:32 AM, L-3, Layout: Plotted By: Andy Patterson, 05/22/15 10:48:11 AM
 XREF: MCD-14.01 - NC 73 Sidewalk Project\800 Drawings\810 Design Drawings\100%CD.dwg, MCD-14.01 - NC 73 Sidewalk Project\800 Drawings\810 Design Drawings\100%CD.dwg

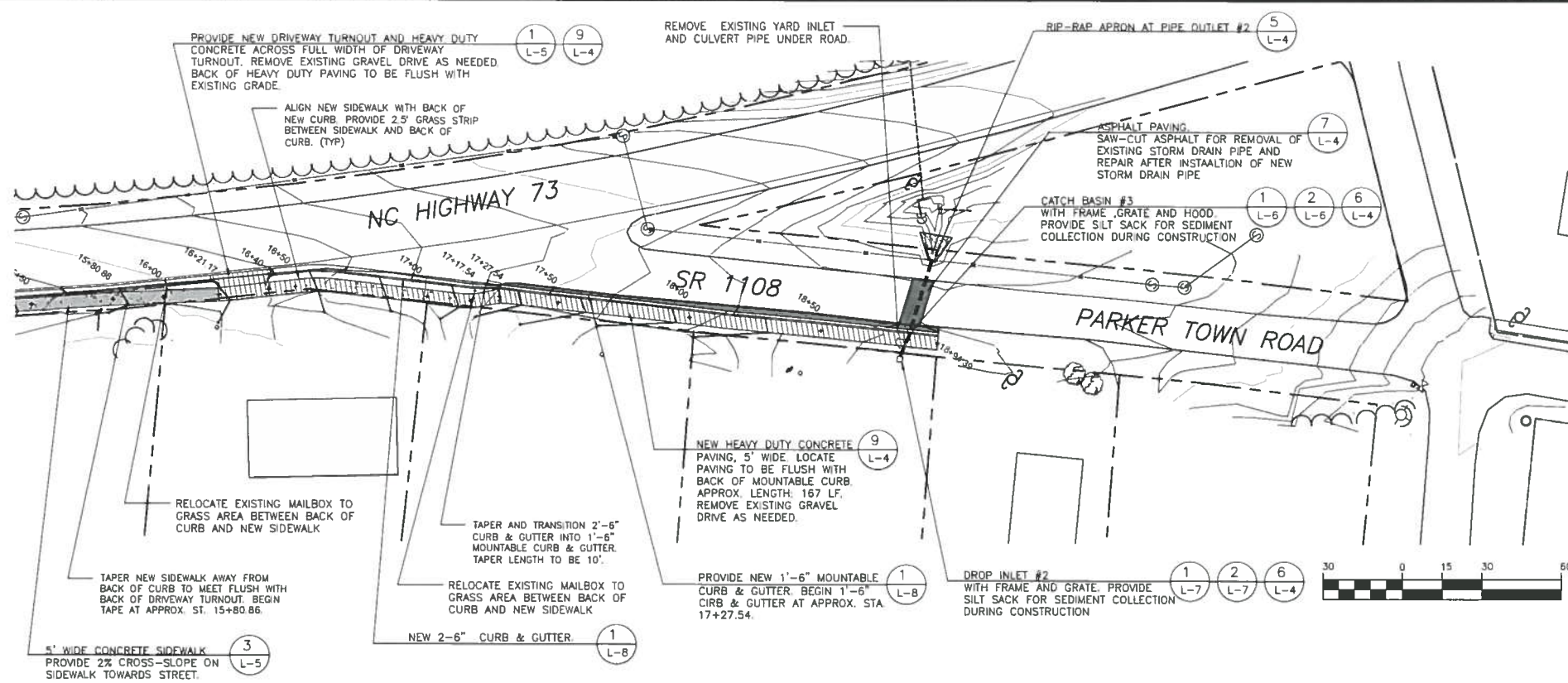

REVISIONS											
SYM.	DESCRIPTION	DATE	BY								
L-3	REVISED PER NCDOT COMMENTS	3-31-15	WLS								

STORM FREQUENCY: 25 YEAR		TIME OF CONCENTRATION: 5 MIN											
LOCATION	AREA(AC.)	C/I	Q=CIA(CFS)		SLOPE		LENGTH	SIZE	VEL.	RIM	INVERT		
FROM	TO	SUB	TOTAL	N	%	FEET	INCH	FPS	ELEV.	OUT	SUB		
CB #1	OUTLET	0.30	0.30	95/8.44	2.41	2.41	.012	0.5	10	15	3.8	421.75	419.50
DI #2	CI #3	0.87	0.67	37/8.44	2.09	2.09	.012	0.5	10	15	3.7	401.75	398.55
CB #3	OUTLET	0.12	0.79	95/8.44	0.96	3.05	.012	0.5	27	15	4.2	401.85	398.40
												INV. IN FR. CB #2	398.50
												PIPE INV. OUT.	419.40
												PIPE INV. OUT.	398.25

4 STORM PIPE SCHEDULE
L-3

1 SIDEWALK LAYOUT PLAN (STA. 16+00 TO STA. 18+94.39)
L-3 SCALE: 1" = 30'-0"
NORTH

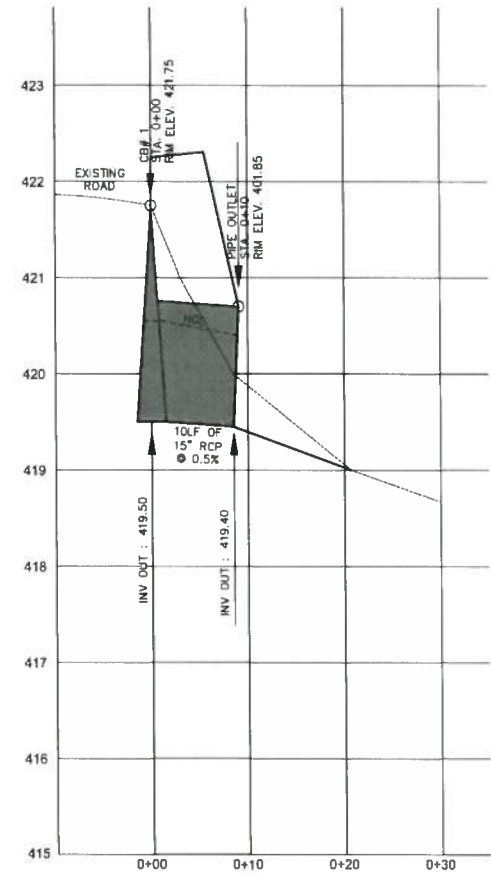

2 STORM DRAINAGE PROFILE CB#1
L-3 SCALE: 1" = 10'-0" HORIZONTAL, 1" = 1'-0" VERTICLE

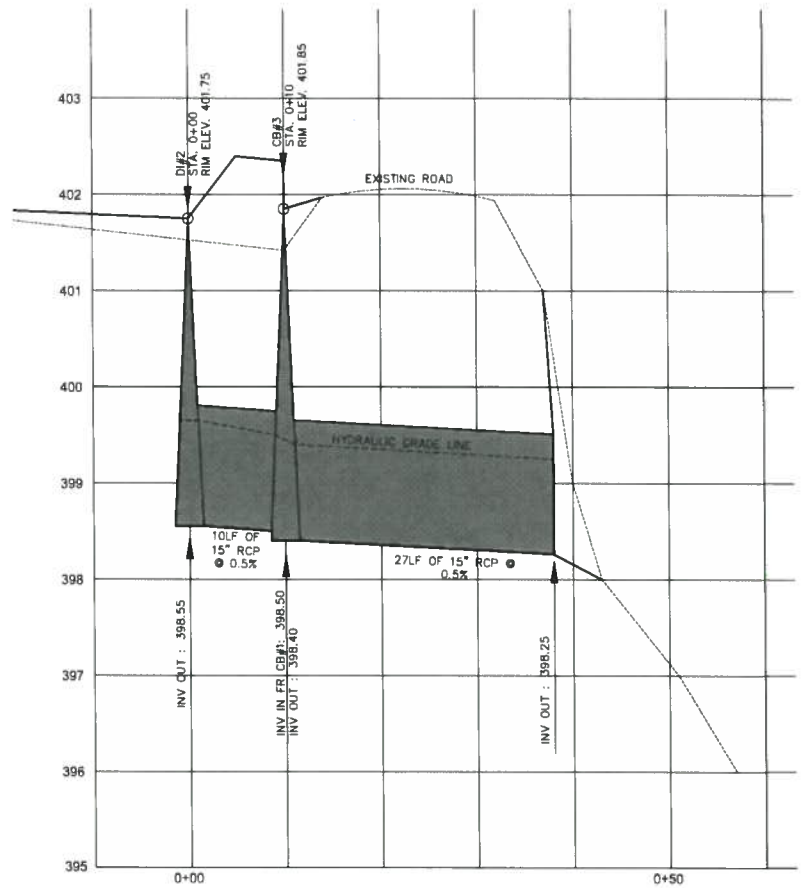

3 STORM DRAINAGE PROFILE DI#2 TO CB#3
L-3 SCALE: 1" = 10'-0" HORIZONTAL, 1" = 1'-0" VERTICLE

NOTE: LOCATIONS OF EXISTING UTILITIES AS SHOWN ARE APPROXIMATE ONLY. EXACT LOCATIONS ARE TO BE VERIFIED IN THE FIELD BY THE CONTRACTOR.



LKC Engineering, PLLC
140 Aqua Shred Court
Aberdeen, NC 28315
O: 910.420.1437
F: 910.637.0096
lkceengineering.com
License No. P-1095

Engineering
Landscape Architecture
Planning

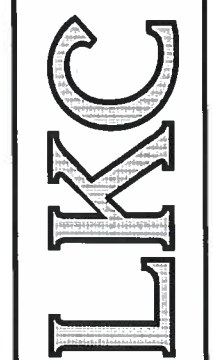

SIDEWALK PLAN

NC HIGHWAY 73
SIDEWALK IMPROVEMENTS
TO SERVE
TOWN OF MOUNT GILEAD
MONTGOMERY COUNTY, NORTH CAROLINA

DATE: MAY, 2015
DESIGNED: WLS
DRAWN: WLS
CHECKED: -
NO.

L:\MGT-14.01 - NC 73 Sidewalk Project\B00 Drawings\810 Design Drawings\100%CD.dwg, Last Saved By: ANDY PATTERSON, 5/27/2015 3:54:26 PM, L-4.dwg, Plotted By: Andy Patterson, 05/04/15 04:21:11 PM
 XREFS: MGD1401-g01.tbl, MGD1401-g02.tbl, MGD1401-g03.tbl, MGD1401-g04.tbl, MGD1401-g05.tbl, MGD1401-g06.tbl, MGD1401-g07.tbl, MGD1401-g08.tbl, MGD1401-g09.tbl, MGD1401-g10.tbl, MGD1401-g11.tbl, MGD1401-g12.tbl, MGD1401-g13.tbl, MGD1401-g14.tbl, MGD1401-g15.tbl, MGD1401-g16.tbl, MGD1401-g17.tbl, MGD1401-g18.tbl, MGD1401-g19.tbl, MGD1401-g20.tbl, MGD1401-g21.tbl, MGD1401-g22.tbl, MGD1401-g23.tbl, MGD1401-g24.tbl, MGD1401-g25.tbl, MGD1401-g26.tbl, MGD1401-g27.tbl, MGD1401-g28.tbl, MGD1401-g29.tbl, MGD1401-g30.tbl, MGD1401-g31.tbl, MGD1401-g32.tbl, MGD1401-g33.tbl, MGD1401-g34.tbl, MGD1401-g35.tbl, MGD1401-g36.tbl, MGD1401-g37.tbl, MGD1401-g38.tbl, MGD1401-g39.tbl, MGD1401-g40.tbl, MGD1401-g41.tbl, MGD1401-g42.tbl, MGD1401-g43.tbl, MGD1401-g44.tbl, MGD1401-g45.tbl, MGD1401-g46.tbl, MGD1401-g47.tbl, MGD1401-g48.tbl, MGD1401-g49.tbl, MGD1401-g50.tbl, MGD1401-g51.tbl, MGD1401-g52.tbl, MGD1401-g53.tbl, MGD1401-g54.tbl, MGD1401-g55.tbl, MGD1401-g56.tbl, MGD1401-g57.tbl, MGD1401-g58.tbl, MGD1401-g59.tbl, MGD1401-g60.tbl, MGD1401-g61.tbl, MGD1401-g62.tbl, MGD1401-g63.tbl, MGD1401-g64.tbl, MGD1401-g65.tbl, MGD1401-g66.tbl, MGD1401-g67.tbl, MGD1401-g68.tbl, MGD1401-g69.tbl, MGD1401-g70.tbl, MGD1401-g71.tbl, MGD1401-g72.tbl, MGD1401-g73.tbl, MGD1401-g74.tbl, MGD1401-g75.tbl, MGD1401-g76.tbl, MGD1401-g77.tbl, MGD1401-g78.tbl, MGD1401-g79.tbl, MGD1401-g80.tbl, MGD1401-g81.tbl, MGD1401-g82.tbl, MGD1401-g83.tbl, MGD1401-g84.tbl, MGD1401-g85.tbl, MGD1401-g86.tbl, MGD1401-g87.tbl, MGD1401-g88.tbl, MGD1401-g89.tbl, MGD1401-g90.tbl, MGD1401-g91.tbl, MGD1401-g92.tbl, MGD1401-g93.tbl, MGD1401-g94.tbl, MGD1401-g95.tbl, MGD1401-g96.tbl, MGD1401-g97.tbl, MGD1401-g98.tbl, MGD1401-g99.tbl, MGD1401-g100.tbl

TEMPORARY SEEDING

SEEDING MIXTURE:
 SPECIES: WINTER RYE (GRAIN), GERMAN MILLET
 RATE: 200 LB/AC, 120 LB/AC
SEEDING DATES:
 WINTER RYE (GRAIN): SEPT. 1 - MAR 1
 GERMAN MILLET: MAR 1 - SEPT. 1
SOIL AMENDMENTS:
 FOLLOW RECOMMENDATIONS OF SOIL TEST OR APPLY 2000 LB/AC. GROUND AGRICULTURAL LIMESTONE AND 750 LB/AC. 10-10-10 FERTILIZER.
MULCH:
 APPLY 4000 LB/AC. STRAW. ANCHOR STRAW BY TACKLING WITH NON-ASPHALTIC TACKIFIER, NETTING, OR A MULCH ANCHORING TOOL. A DISK WITH BLADES TURNED NEARLY STRAIGHT CAN BE USED AS AN ANCHORING TOOL.
MAINTENANCE:
 REFERTILIZE IF GROWTH IS NOT ADEQUATE. RESEED, REFERTILIZE, AND MULCH IMMEDIATELY FOLLOWING EROSION OR OTHER DAMAGE.
NOTE: TEMPORARY SEED MIX SHALL BE USED FOR ALL AREAS EXPOSED GREATER THAN ONE WEEK AND SUBJECT TO FURTHER DISTURBANCE.

PERMANENT SEEDING

COMMON BERMUDA SEED 2 LB./1000 SF
SEEDING DATES:
 COMMON BERMUDA: MAR. 1 - NOV. 1
SOIL AMENDMENTS: COMMON BERMUDA
 FOLLOW RECOMMENDATIONS OF SOIL TEST OR APPLY 3000 LB/AC. GROUND AGRICULTURAL LIMESTONE AND 875 LB/AC. 10-10-10 FERTILIZER. ADD 25-50 LBS/ACRE NITROGEN AT 2-3 WEEK INTERVALS THROUGH MIDSUMMER.
MULCH:
 STRAW MULCH
MAINTENANCE:
 SUPPLEMENT RAINFALL WITH WATER AS NEEDED TO COMPLY WITH ONE INCH OF WATER PER WEEK MINIMUM AND MOW TO 3/4" TO 1" HEIGHT. TOPDRESS WITH 40 lbs/ ACRE NITROGEN IN APR., 50lbs IN JUNE, 30 lbs IN JULY, AND 25-50 lbs IN AUG.
NOTE: PERMANENT SEED MIX SHALL BE CHECKED FOR ADEQUACY ON JULY 15.

2 SEEDING SCHEDULE

1. GROUND STABILIZATION REQUIREMENTS

CONTRACTOR SHALL BE REQUIRED TO ESTABLISH GROUND STABILIZATION AS PER FOLLOWING CHART.		
SITE AREA DESCRIPTION	STABILIZATION TIME FRAME	STABILIZATION TIME FRAME EXCEPTIONS
PERIMETER DIKES, SWALES, DITCHES AND SLOPES	7 DAYS	NONE
HIGH QUALITY WATER (HQW) ZONES	7 DAYS	NONE
SLOPES STEEPER THAN 3:1	7 DAYS	IF SLOPES ARE 10' OR LESS IN LENGTH AND ARE NOT STEEPER THAN 2:1, 14 DAYS ARE ALLOWED
SLOPES 3:1 OR FLATTER	14 DAYS	7 DAYS FOR SLOPES GREATER THAN 50 FEET IN LENGTH
ALL OTHER AREAS WITH SLOPES FLATTER THAN 4:1	14 DAYS	NONE (EXCEPT FOR PERIMETERS AND HQW ZONES)
TYPICAL GROUND COVER STABILIZATION TYPES - GRASS AND OR SOD, WHEAT STRAW, MULCH, BIODEGRADABLE STRAW MATTING, SYNTHETIC MATTING, ETC.		

- SEED BED PREPARATION
- RIP THE ENTIRE AREA TO 6 INCH DEPTH.
- REMOVE ALL LOOSE ROCK, ROOTS, AND OTHER OBSTRUCTIONS LEAVING SURFACE REASONABLY SMOOTH AND UNIFORM.
- APPLY AGRICULTURAL LIME, FERTILIZER AND SUPERPHOSPHATE IN ACCORDANCE WITH "SEEDING SCHEDULE" AND MIX WITH SOIL.
- CONTINUE TILLAGE UNTIL A WELL-PULVERIZED, FIRM, REASONABLY UNIFORM SEED BED IS PREPARED 4 TO 6 INCHES DEEP.
- SEED ON A FRESHLY PREPARED SEED BED AND COVER SEED LIGHTLY WITH SEEDING EQUIPMENT OR CULTIPACK AFTER SEEDING. SEED ACCORDING TO "SEEDING SCHEDULE".
- MULCH IN ACCORDANCE WITH "SEEDING SCHEDULE" IMMEDIATELY AFTER SEEDING.
- INSPECT ALL SEEDING FOR COMPLIANCE WITH THE REQUIREMENTS OF THE "SEEDING SCHEDULE". MAKE NECESSARY REPAIRS AND RESEED WITHIN THE PLANTING SEASON, IF POSSIBLE. OR THE DAMAGED AREA SHALL BE REESTABLISHED FOLLOWING THE ORIGINAL LIME, FERTILIZER AND SEEDING REQUIREMENTS.

4 SEEDBED PREPARATION

VELOCITY DISSIPATOR SCHEDULE							
FES #	DIA	ZONE	L	W ₁	W ₂	CLASS	THICKNESS
outlet 1	18"	2	10	3.5	13.5	B	18"

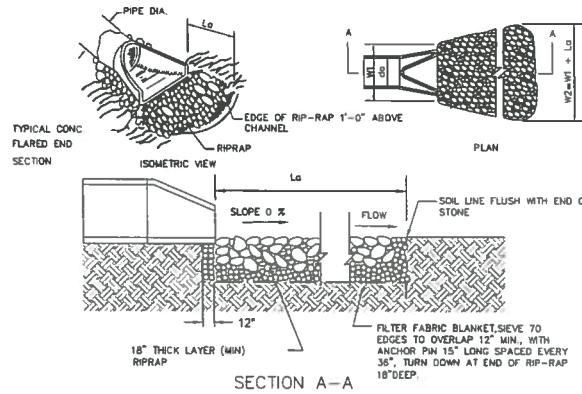

MAINTENANCE:
 INSPECT RIPRAP OUTLET STRUCTURES WEEKLY AND AFTER SIGNIFICANT RAINFALL EVENTS (1/2" OR GREATER) TO SEE IF ANY EROSION AROUND OR BELOW THE RIPRAP HAS TAKEN PLACE. OR IF STONES HAVE BEEN DISLODGED. IMMEDIATELY MAKE ALL REPAIRS TO PREVENT FURTHER DAMAGE.

5 RIPRAP APRON DETAIL

NOT TO SCALE

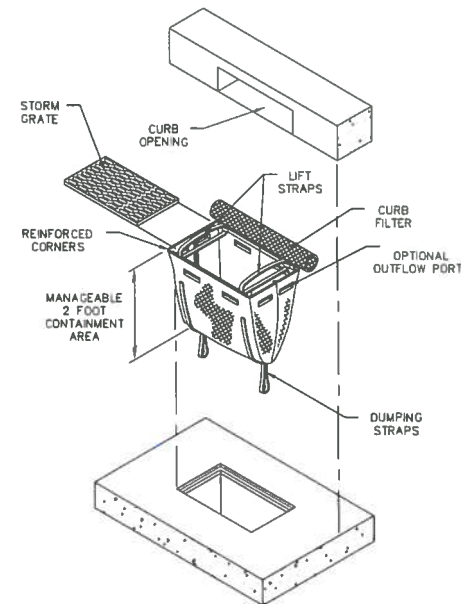

- NOTES & MAINTENANCE:**
- INSPECT SEDIMENT BAG AT LEAST ONCE A WEEK AND AFTER EACH RAINFALL. MAKE ANY REQUIRED REPAIRS IMMEDIATELY.
 - IF THE FABRIC OF A SEDIMENT BAG COLLAPSE, TEAR, DECOMPOSE OR BECOME INEFFECTIVE, REPLACE IT PROMPTLY.
 - REMOVE SEDIMENT DEPOSITS AS NECESSARY TO PROVIDE ADEQUATE STORAGE VOLUME FOR THE NEXT RAIN AND REDUCE PRESSURE ON THE BAG.
 - REMOVE SEDIMENT DEEPER THAN 12"
 - SEDIMENT BAG/INLET PROTECTION TO BE DANDY CURB SACK BY DANDY PRODUCTS, INC. PHONE #: 1-800-591-2284, OR EQUAL.

6 STORM INLET PROTECTION

NOT TO SCALE

3 DWQ GROUND STABILIZATION CHART

NOT TO SCALE

REVISIONS			
SYM.	DESCRIPTION	DATE	BY
		3-31-15	WLS

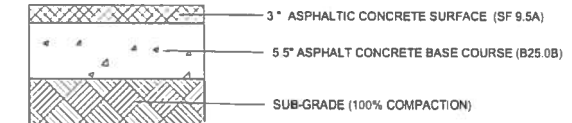

PAVEMENT PROFILE PER CIVIL DRAWINGS

7 ASPHALT PAVING DETAIL

NOT TO SCALE

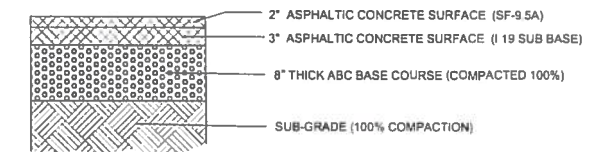

PAVEMENT PROFILE PER CIVIL DRAWINGS

8 HEAVY DUTY ASPHALT DETAIL

NOT TO SCALE

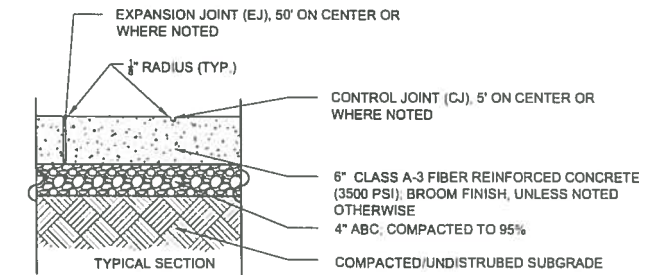

- NOTES:**
- CONCRETE SIDEWALK TO BE 5' WIDE AND 4" THICK, UNLESS NOTED OTHERWISE ON PLANS
 - PLACE A GROOVE JOINT 1" DEEP WITH 1/2" RADIUS IN THE CONCRETE SIDEWALK AT 5' INTERVALS. ONE 1/2" EXPANSION JOINT WILL BE REQUIRED AT 50' INTERVALS. A 1/2" EXPANSION JOINT WILL BE REQUIRED WHERE THE SIDEWALK JOINS ANY EXISTING RIGID SURFACE OR STRUCTURE
 - EXPANSION JOINT TO BE FILLED WITH JOINT FILLER AND CAPPED WITH JOINT SEALER.

9 HEAVY-DUTY CONCRETE DETAIL

NOT TO SCALE

NOTE: LOCATIONS OF EXISTING UTILITIES AS SHOWN ARE APPROXIMATE ONLY. EXACT LOCATIONS ARE TO BE VERIFIED IN THE FIELD BY THE CONTRACTOR.



BEFORE YOU DIG!
CALL 1-800-832-4949
NC ONE-CALL CENTER
IT'S THE LAW!

LKC Engineering, PLLC
 140 Aqua Shed Court
 Aberdeen, NC 28315
 O: 910.420.1437
 F: 910.637.0096
 lkceengineering.com
 License No. P-1095

Engineering
 Landscape Architecture
 Planning

LKC

DETAILS

NC HIGHWAY 73
 SIDEWALK IMPROVEMENTS
 TO SERVE
 TOWN OF MOUNT GILEAD
 MONTGOMERY COUNTY, NORTH CAROLINA

DATE: MAY, 2015

DESIGNED: WLS

DRAWN: WLS

CHECKED: -

NO.

L-4

REVISIONS			
SYM.	DESCRIPTION	DATE	BY
REVISED PER	NC DOT COMMENTS	3-31-15	WLS

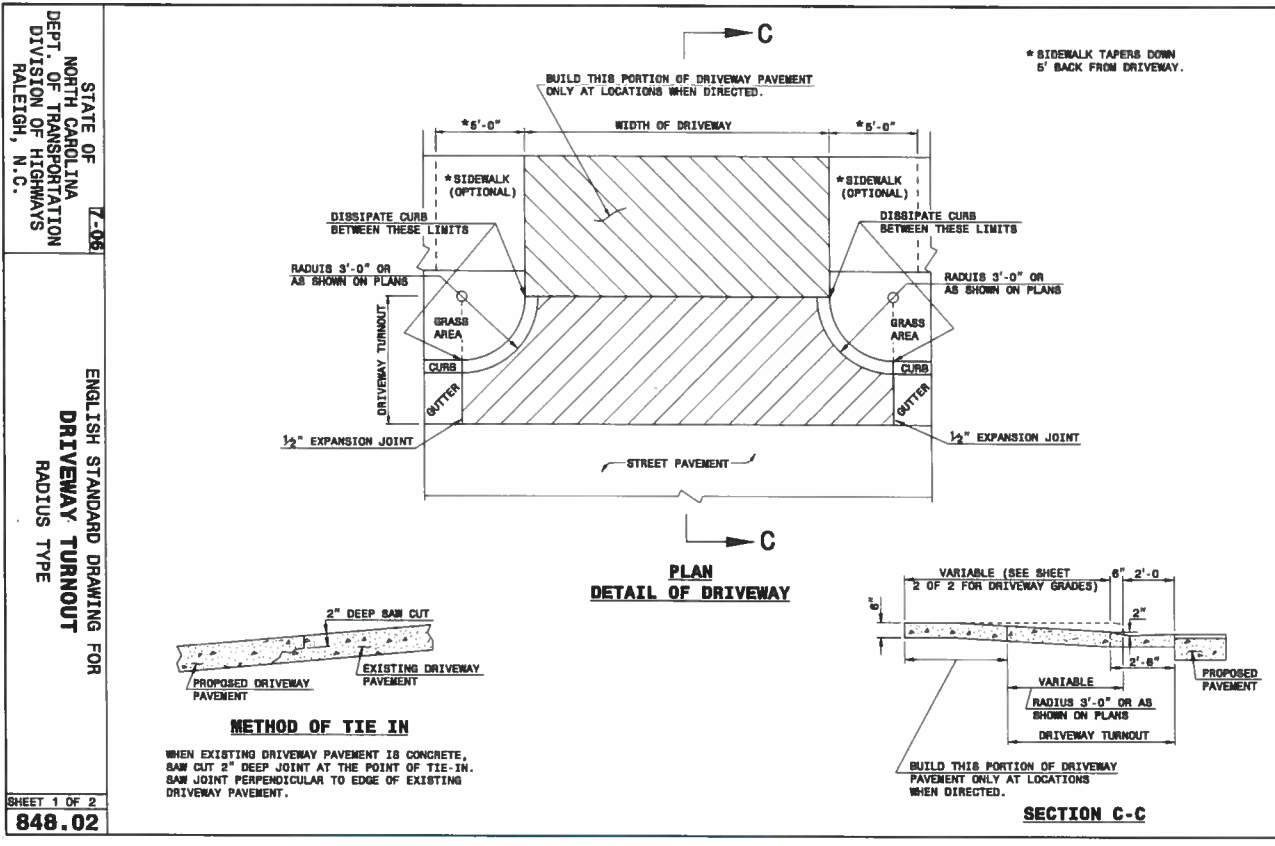

STATE OF NORTH CAROLINA
DEPT. OF TRANSPORTATION
DIVISION OF HIGHWAYS
RALEIGH, N.C.

ENGLISH STANDARD DRAWING FOR
DRIVEWAY TURNOUT
RADIUS TYPE

SHEET 1 OF 2
848.02

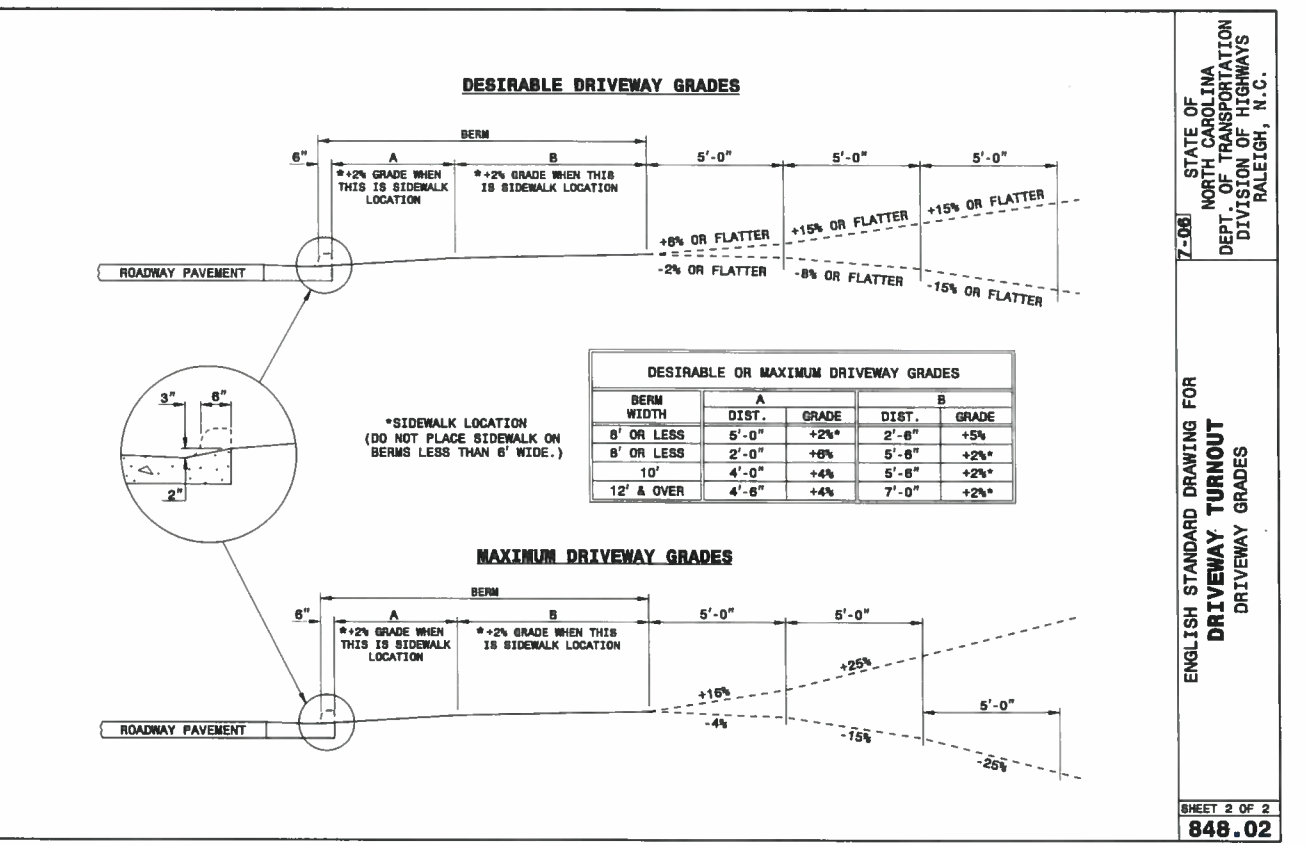

STATE OF NORTH CAROLINA
DEPT. OF TRANSPORTATION
DIVISION OF HIGHWAYS
RALEIGH, N.C.

ENGLISH STANDARD DRAWING FOR
DRIVEWAY TURNOUT
DRIVEWAY GRADES

SHEET 2 OF 2
848.02

1 DRIVEWAY TURNOUT DETAIL
L-5 NOT TO SCALE

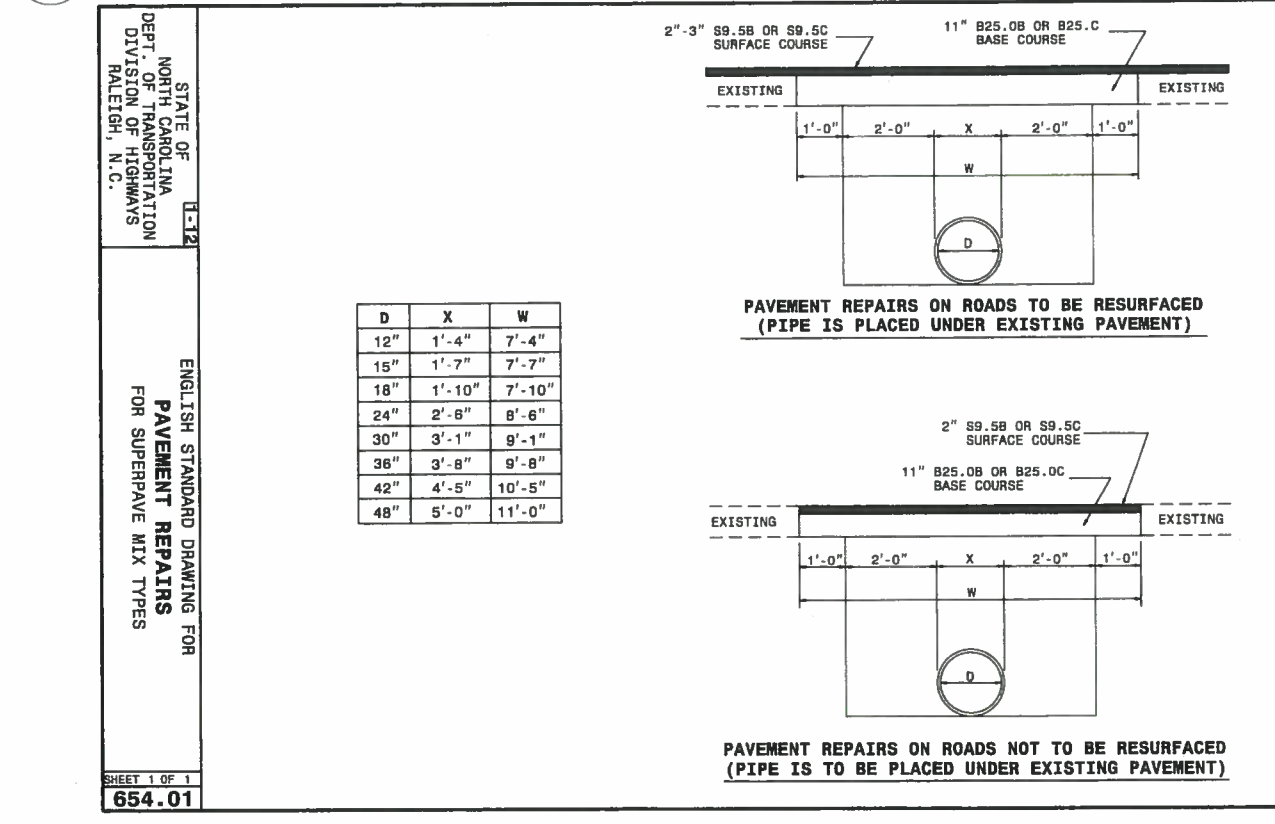

STATE OF NORTH CAROLINA
DEPT. OF TRANSPORTATION
DIVISION OF HIGHWAYS
RALEIGH, N.C.

ENGLISH STANDARD DRAWING FOR
PAVEMENT REPAIRS
FOR SUPERPAVE MIX TYPES

SHEET 1 OF 1
654.01

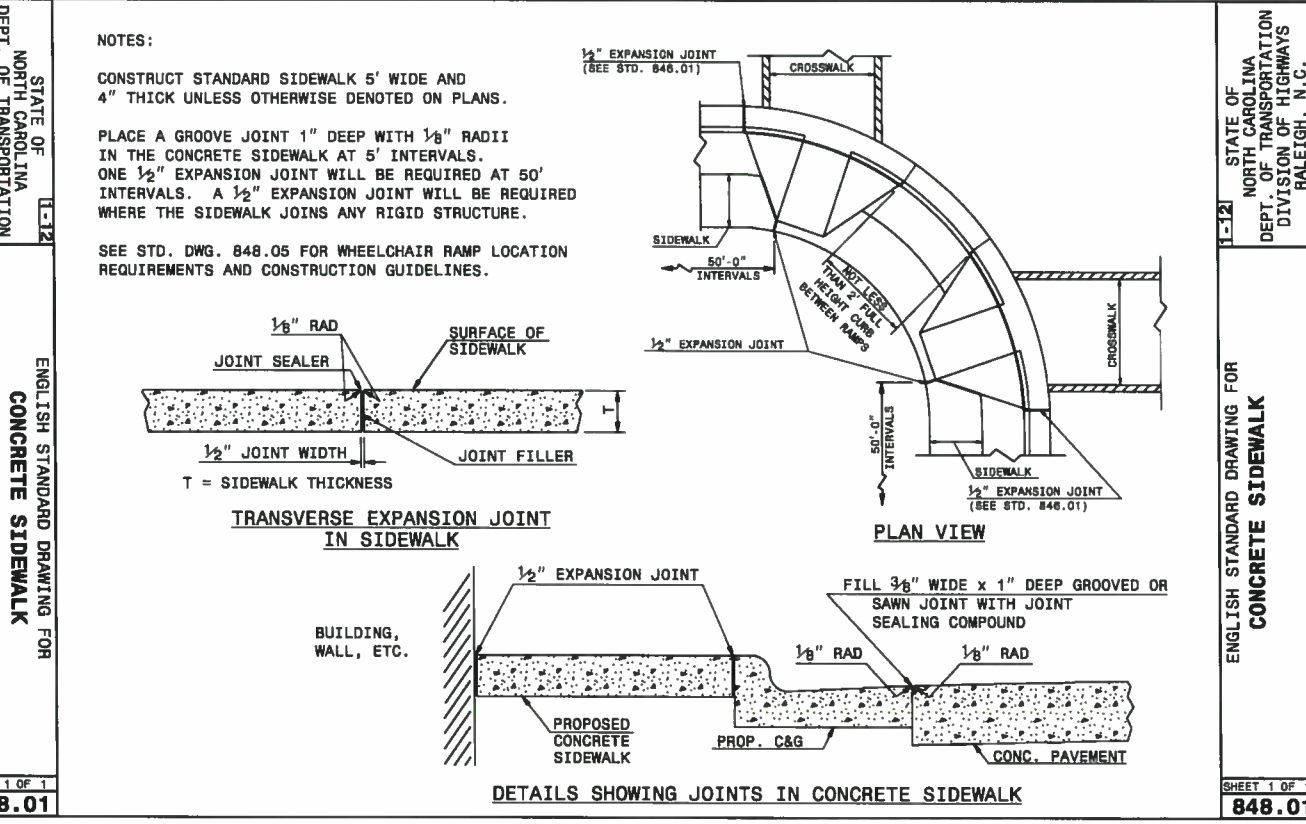

STATE OF NORTH CAROLINA
DEPT. OF TRANSPORTATION
DIVISION OF HIGHWAYS
RALEIGH, N.C.

ENGLISH STANDARD DRAWING FOR
CONCRETE SIDEWALK

SHEET 1 OF 1
848.01

2 PAVEMENT REPAIR DETAIL
L-5 NOT TO SCALE

3 CONCRETE SIDEWALK DETAIL
L-5 NOT TO SCALE

LKC Engineering, PLLC
140 Aqua Shed Court
Aberdeen, NC 28315
O: 910.420.1437
F: 910.637.0096
lkceengineering.com
License No. P-1095

Engineering
Landscape Architecture
Planning



DETAILS

NC HIGHWAY 73
SIDEWALK IMPROVEMENTS
TO SERVE
TOWN OF MOUNT GILEAD
MONTGOMERY COUNTY, NORTH CAROLINA

DATE: MAY, 2015
DESIGNED: WLS
DRAWN: WLS
CHECKED: -
NO.

L-5

L:\MGS-14.01 - NC 73 Sidewalk Project\B10 Drawings\100%CD.dwg, Last Saved By: ANDY PATTERSON, 5/22/2015 10:43:32 AM, L-5 Details, Plotted By: Andy Peterson, 05/22/15 10:51:39 AM
XREF: MGS-14.01 - g011b01.dwg, IMAG: L:\MGS-14.01 - NC 73 Sidewalk Project\B10 Drawings\B10 Design Drawings\DETAIL_TIF\09400201.tif

L:\MCD-14.01 - NC 73 Sidewalk Project\800 Drawings\810 Design Drawings\800 Drawings\810 Design Drawings\810 DETAIL_TIP_08480201.dwg
 XREFS: MCD14.01 - NC 73 Sidewalk Project\800 Drawings\810 Design Drawings\800 Drawings\810 Design Drawings\810 DETAIL_TIP_08480201.dwg
 L:\MCD-14.01 - NC 73 Sidewalk Project\800 Drawings\810 Design Drawings\800 Drawings\810 Design Drawings\810 DETAIL_TIP_08480201.dwg
 PLOTTED BY: Andy Patterson, 05/22/2015 10:52:01 AM

REVISIONS			
SYM.	DESCRIPTION	DATE	BY
1	REVISED PER NCDOT COMMENTS	3-31-15	WLS



STATE OF NORTH CAROLINA DEPT. OF TRANSPORTATION DIVISION OF HIGHWAYS RALEIGH, N. C.

ENGLISH STANDARD DRAWING FOR BRICK CATCH BASIN 12" THRU 54" PIPE

NOTE: MORTAR JOINTS 1/2" +/- 1/8" THICK. USE GLASS "B" CONCRETE THROUGHOUT. USE FORMS FOR CONSTRUCTION OF THE BOTTOM SLAB. DEDUCT FOR PIPE(S) FROM TOTAL CU. YDS. OF BRICK MASONRY. USE #4 BAR DOWELS AT 12" CENTERS. PROVIDE ALL CATCH BASINS OVER 3'-8" IN DEPTH WITH STEPS 12" ON CENTER. USE STEPS WHICH COMPLY WITH STD. DRAWING 840.66. USE TYPE "E", "F" AND "G" GRATES UNLESS OTHERWISE INDICATED. USE BRICK OR CONCRETE BLOCK WHICH COMPLIES WITH THE REQUIREMENTS OF SECTION 840 OF THE STANDARD SPECIFICATIONS. IF REINFORCED CONCRETE PIPE IS SET IN BOTTOM SLAB OF BOX, ADD TO SLAB AS SHOWN ON STD. NO. 840.00. FOR 8'-0" IN HEIGHT OR LESS, USE 8" WALL. OVER 8'-0" IN HEIGHT, USE 12" WALL TO 8'-0" FROM TOP OF WALL AND 8" WALL FOR THE REMAINING 6'-0". QUANTITIES TO BE ADJUSTED ACCORDINGLY. CONSTRUCT WITH PIPE CROWNS MATCHING. CHAMFER ALL EXPOSED CORNERS 1". DRAWING NOT TO SCALE.

STATE OF NORTH CAROLINA DEPT. OF TRANSPORTATION DIVISION OF HIGHWAYS RALEIGH, N. C.

ENGLISH STANDARD DRAWING FOR BRICK CATCH BASIN 12" THRU 54" PIPE

SHEET 1 OF 2 840.01

STATE OF NORTH CAROLINA DEPT. OF TRANSPORTATION DIVISION OF HIGHWAYS RALEIGH, N. C.

ENGLISH STANDARD DRAWING FOR BRICK CATCH BASIN 12" THRU 54" PIPE

STATE OF NORTH CAROLINA DEPT. OF TRANSPORTATION DIVISION OF HIGHWAYS RALEIGH, N. C.

ENGLISH STANDARD DRAWING FOR BRICK CATCH BASIN 12" THRU 54" PIPE

SHEET 2 OF 2 840.01

PIPE	DIMENSIONS OF BOX AND PIPE				DIMENSIONS			TOTAL LBS.	TOP SLAB	BOTTOM CONC.	IN BOX	BRICK MASONRY	REDUCTIONS	
	SPAN	WIDTH	DEPTH	MIN. HEIGHT	E	F	G						ONE PIPE	TWO PIPE
12"	3'-0"	2'-2"	2'-2"	2'-9"	2'-9"	2'-9"	2'-9"	0.281	0.281	0.883	1.184	0.020	0.042	
15"	3'-0"	2'-2"	2'-2"	3'-0"	3'-0"	3'-0"	3'-0"	0.281	0.281	0.883	1.244	0.031	0.047	
18"	3'-0"	2'-2"	2'-2"	3'-3"	3'-3"	3'-3"	3'-3"	0.281	0.281	1.043	1.324	0.044	0.065	
24"	3'-0"	2'-2"	2'-2"	3'-9"	3'-9"	3'-9"	3'-9"	0.281	0.281	1.204	1.485	0.078	0.121	
30"	3'-0"	2'-2"	3'-4"	4'-3"	1'-2"	4'-4"	4'-4"	0.374	0.374	0.521	1.666	2.217	0.164	
36"	3'-0"	2'-2"	3'-10"	4'-9"	1'-8"	4'-4"	4'-4"	0.167	0.415	0.602	1.914	2.518	0.261	
42"	3'-0"	2'-2"	4'-6"	5'-3"	1'-5"	3'-6"	4'-1"	0.138	0.372	0.508	2.162	2.660	0.240	
48"	3'-0"	2'-2"	5'-0"	5'-9"	2'-0"	3'-6"	4'-1"	0.173	0.410	0.583	2.415	2.998	0.313	
54"	3'-0"	2'-2"	5'-7"	6'-3"	2'-7"	3'-8"	4'-3"	0.211	0.448	0.659	2.806	3.485	0.398	

* RISER HAS .321 CUBIC YARDS OF BRICK MASONRY PER FOOT HEIGHT

STATE OF NORTH CAROLINA DEPT. OF TRANSPORTATION DIVISION OF HIGHWAYS RALEIGH, N. C.

ENGLISH STANDARD DRAWING FOR BRICK CATCH BASIN 12" THRU 54" PIPE

SHEET 2 OF 2 840.01

1 BRICK CATCH BASIN DETAIL
 NOT TO SCALE

STATE OF NORTH CAROLINA DEPT. OF TRANSPORTATION DIVISION OF HIGHWAYS RALEIGH, N. C.

ENGLISH STANDARD DRAWING FOR FRAME, GRATES, AND HOOD FOR USE ON STANDARD CATCH BASIN

NOTE: USE TYPE "E", "F" AND "G" GRATE UNLESS OTHERWISE NOTED.

STATE OF NORTH CAROLINA DEPT. OF TRANSPORTATION DIVISION OF HIGHWAYS RALEIGH, N. C.

ENGLISH STANDARD DRAWING FOR FRAME, GRATES, AND HOOD FOR USE ON STANDARD CATCH BASIN

SHEET 2 OF 2 840.03

STATE OF NORTH CAROLINA DEPT. OF TRANSPORTATION DIVISION OF HIGHWAYS RALEIGH, N. C.

ENGLISH STANDARD DRAWING FOR FRAME, GRATES, AND HOOD FOR USE ON STANDARD CATCH BASIN

STATE OF NORTH CAROLINA DEPT. OF TRANSPORTATION DIVISION OF HIGHWAYS RALEIGH, N. C.

ENGLISH STANDARD DRAWING FOR FRAME, GRATES, AND HOOD FOR USE ON STANDARD CATCH BASIN

SHEET 1 OF 2 840.03

2 CATCH BASIN FRAME, GRATE & HOOD DETAIL
 NOT TO SCALE

LKC Engineering, PLLC
 140 Aqua Shed Court
 Aberdeen, NC 28315
 O: 910.420.1437
 F: 910.637.0096
 lkceengineering.com
 License No. P-1095

Engineering
 Landscape Architecture
 Planning

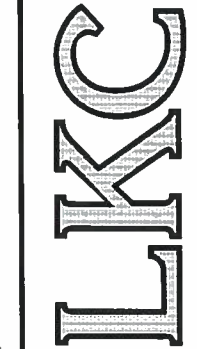

DETAILS

NC HIGHWAY 73
 SIDEWALK IMPROVEMENTS
 TO SERVE
 TOWN OF MOUNT GILEAD
 MONTGOMERY COUNTY, NORTH CAROLINA

DATE: MAY, 2015
 DESIGNED: WLS
 DRAWN: WLS
 CHECKED: -
 NO.

REVISIONS			
SYM.	DESCRIPTION	DATE	BY
REVISED PER	NCDOT COMMENTS	3-31-15	WLS

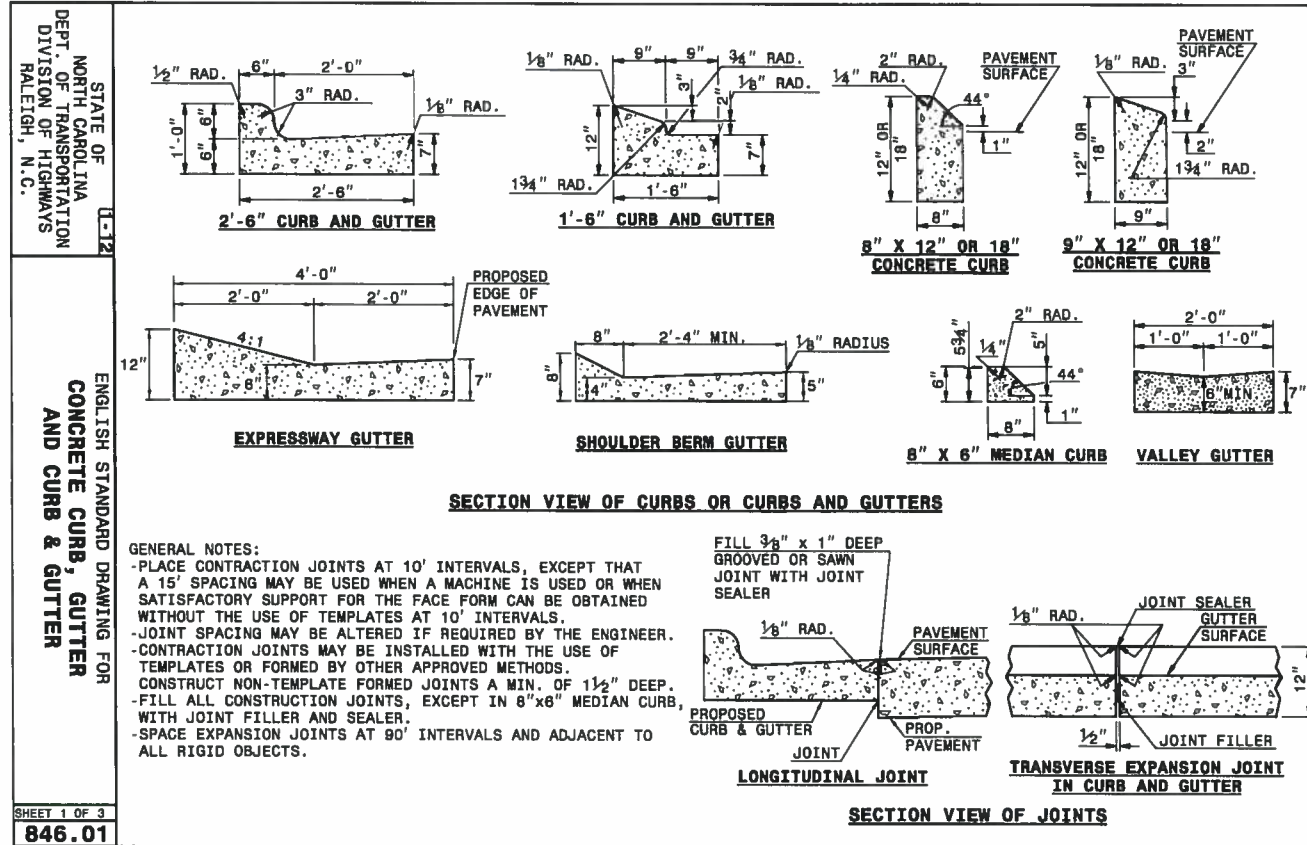

STATE OF NORTH CAROLINA
 DEPT. OF TRANSPORTATION
 DIVISION OF HIGHWAYS
 RALEIGH, N.C.

ENGLISH STANDARD DRAWING FOR
CONCRETE CURB, GUTTER AND CURB & GUTTER

SHEET 1 OF 3
846.01

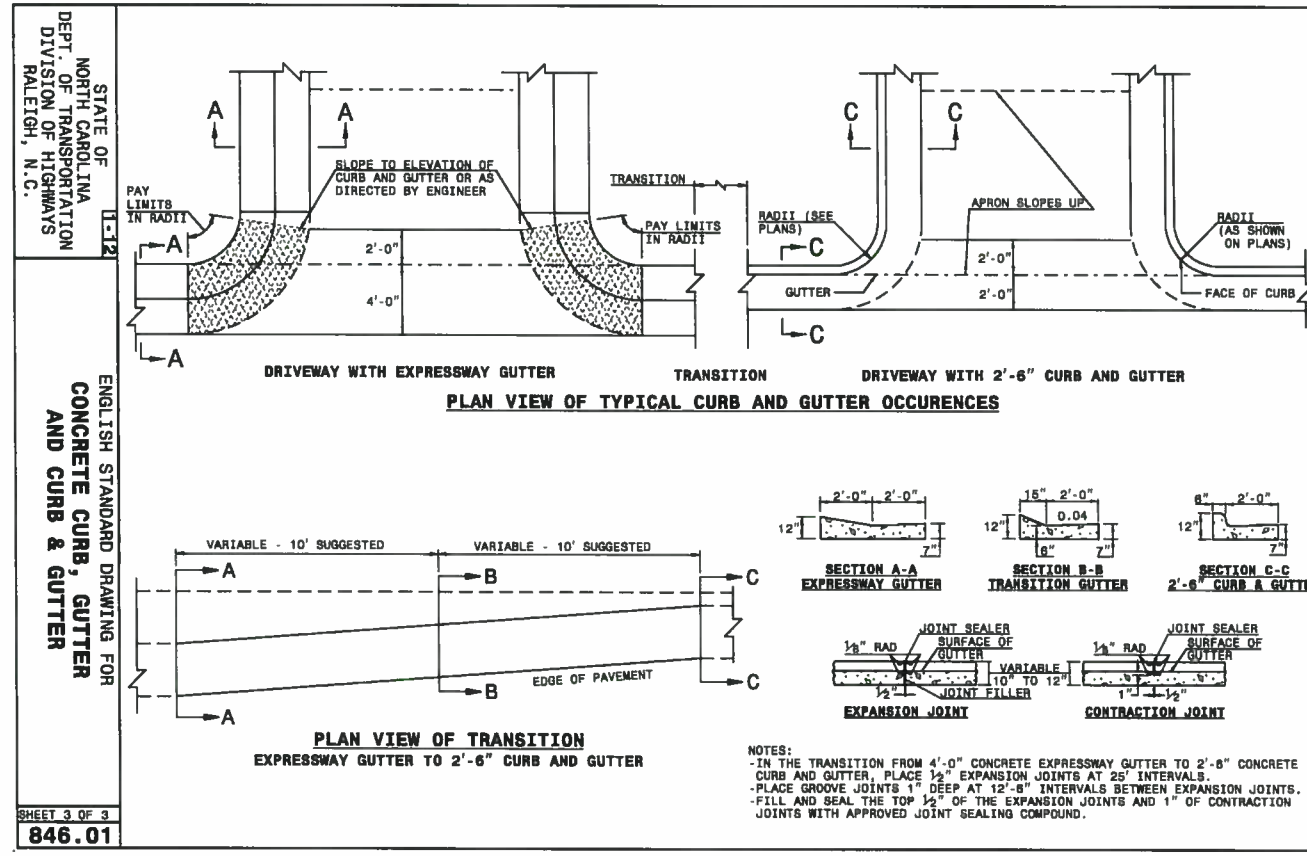
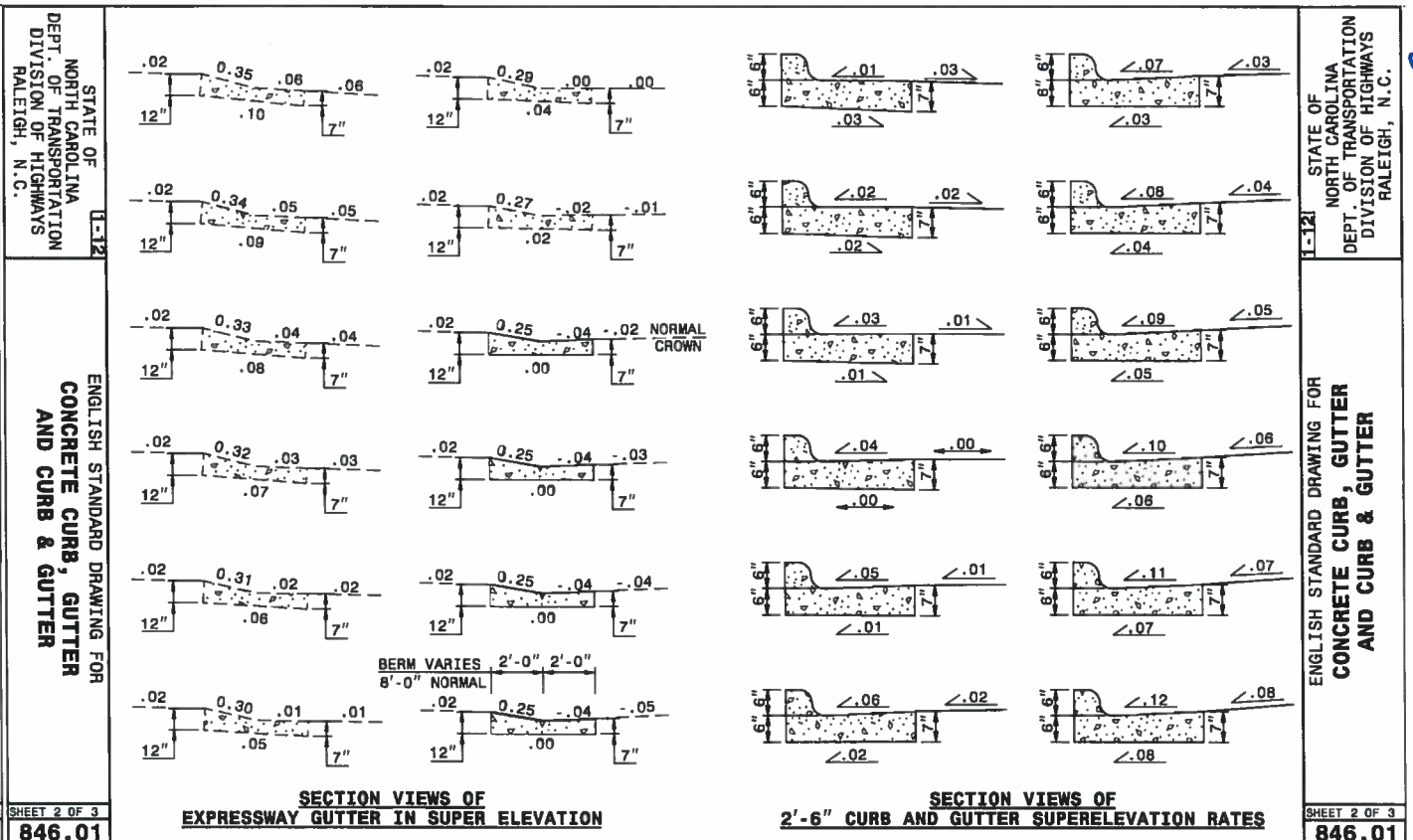

STATE OF NORTH CAROLINA
 DEPT. OF TRANSPORTATION
 DIVISION OF HIGHWAYS
 RALEIGH, N.C.

ENGLISH STANDARD DRAWING FOR
CONCRETE CURB, GUTTER AND CURB & GUTTER

SHEET 3 OF 3
846.01

1 CURB AND GUTTER DETAIL
 L-8 NOT TO SCALE

LKC Engineering, PLLC
 140 Aqua Shed Court
 Aberdeen, NC 28315
 O: 910.420.1437
 F: 910.637.0096
 lkceengineering.com
 License No. P-1095

Engineering
 Landscape Architecture
 Planning

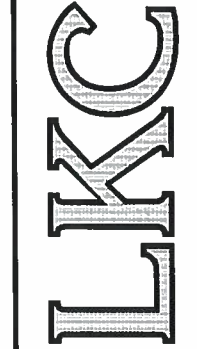

DETAILS

NC HIGHWAY 73
 SIDEWALK IMPROVEMENTS
 TO SERVE
 TOWN OF MOUNT GILEAD
 MONTGOMERY COUNTY, NORTH CAROLINA

DATE: MAY, 2015
 DESIGNED: WLS
 DRAWN: WLS
 CHECKED: -
 NO.

L-8

L:\MCD-14.01 - NC 73 Sidewalk Project\800 Drawings\810 Design Drawings\005\CD.dwg; Last Saved By: ANDY PATTERSON, 5/22/2015, 10:51:49 AM; L-8 Detail; Plotted By: Andy Patterson, 05/22/15 10:52:45 AM
 XREFs: MCD1401-801.dwg; MCD1401-802.dwg; MCD1401-803.dwg; MCD1401-804.dwg; MCD1401-805.dwg; MCD1401-806.dwg; MCD1401-807.dwg; MCD1401-808.dwg; MCD1401-809.dwg; MCD1401-810.dwg; MCD1401-811.dwg; MCD1401-812.dwg; MCD1401-813.dwg; MCD1401-814.dwg; MCD1401-815.dwg; MCD1401-816.dwg; MCD1401-817.dwg; MCD1401-818.dwg; MCD1401-819.dwg; MCD1401-820.dwg; MCD1401-821.dwg; MCD1401-822.dwg; MCD1401-823.dwg; MCD1401-824.dwg; MCD1401-825.dwg; MCD1401-826.dwg; MCD1401-827.dwg; MCD1401-828.dwg; MCD1401-829.dwg; MCD1401-830.dwg; MCD1401-831.dwg; MCD1401-832.dwg; MCD1401-833.dwg; MCD1401-834.dwg; MCD1401-835.dwg; MCD1401-836.dwg; MCD1401-837.dwg; MCD1401-838.dwg; MCD1401-839.dwg; MCD1401-840.dwg; MCD1401-841.dwg; MCD1401-842.dwg; MCD1401-843.dwg; MCD1401-844.dwg; MCD1401-845.dwg; MCD1401-846.dwg; MCD1401-847.dwg; MCD1401-848.dwg; MCD1401-849.dwg; MCD1401-850.dwg; MCD1401-851.dwg; MCD1401-852.dwg; MCD1401-853.dwg; MCD1401-854.dwg; MCD1401-855.dwg; MCD1401-856.dwg; MCD1401-857.dwg; MCD1401-858.dwg; MCD1401-859.dwg; MCD1401-860.dwg; MCD1401-861.dwg; MCD1401-862.dwg; MCD1401-863.dwg; MCD1401-864.dwg; MCD1401-865.dwg; MCD1401-866.dwg; MCD1401-867.dwg; MCD1401-868.dwg; MCD1401-869.dwg; MCD1401-870.dwg; MCD1401-871.dwg; MCD1401-872.dwg; MCD1401-873.dwg; MCD1401-874.dwg; MCD1401-875.dwg; MCD1401-876.dwg; MCD1401-877.dwg; MCD1401-878.dwg; MCD1401-879.dwg; MCD1401-880.dwg; MCD1401-881.dwg; MCD1401-882.dwg; MCD1401-883.dwg; MCD1401-884.dwg; MCD1401-885.dwg; MCD1401-886.dwg; MCD1401-887.dwg; MCD1401-888.dwg; MCD1401-889.dwg; MCD1401-890.dwg; MCD1401-891.dwg; MCD1401-892.dwg; MCD1401-893.dwg; MCD1401-894.dwg; MCD1401-895.dwg; MCD1401-896.dwg; MCD1401-897.dwg; MCD1401-898.dwg; MCD1401-899.dwg; MCD1401-900.dwg; MCD1401-901.dwg; MCD1401-902.dwg; MCD1401-903.dwg; MCD1401-904.dwg; MCD1401-905.dwg; MCD1401-906.dwg; MCD1401-907.dwg; MCD1401-908.dwg; MCD1401-909.dwg; MCD1401-910.dwg; MCD1401-911.dwg; MCD1401-912.dwg; MCD1401-913.dwg; MCD1401-914.dwg; MCD1401-915.dwg; MCD1401-916.dwg; MCD1401-917.dwg; MCD1401-918.dwg; MCD1401-919.dwg; MCD1401-920.dwg; MCD1401-921.dwg; MCD1401-922.dwg; MCD1401-923.dwg; MCD1401-924.dwg; MCD1401-925.dwg; MCD1401-926.dwg; MCD1401-927.dwg; MCD1401-928.dwg; MCD1401-929.dwg; MCD1401-930.dwg; MCD1401-931.dwg; MCD1401-932.dwg; MCD1401-933.dwg; MCD1401-934.dwg; MCD1401-935.dwg; MCD1401-936.dwg; MCD1401-937.dwg; MCD1401-938.dwg; MCD1401-939.dwg; MCD1401-940.dwg; MCD1401-941.dwg; MCD1401-942.dwg; MCD1401-943.dwg; MCD1401-944.dwg; MCD1401-945.dwg; MCD1401-946.dwg; MCD1401-947.dwg; MCD1401-948.dwg; MCD1401-949.dwg; MCD1401-950.dwg; MCD1401-951.dwg; MCD1401-952.dwg; MCD1401-953.dwg; MCD1401-954.dwg; MCD1401-955.dwg; MCD1401-956.dwg; MCD1401-957.dwg; MCD1401-958.dwg; MCD1401-959.dwg; MCD1401-960.dwg; MCD1401-961.dwg; MCD1401-962.dwg; MCD1401-963.dwg; MCD1401-964.dwg; MCD1401-965.dwg; MCD1401-966.dwg; MCD1401-967.dwg; MCD1401-968.dwg; MCD1401-969.dwg; MCD1401-970.dwg; MCD1401-971.dwg; MCD1401-972.dwg; MCD1401-973.dwg; MCD1401-974.dwg; MCD1401-975.dwg; MCD1401-976.dwg; MCD1401-977.dwg; MCD1401-978.dwg; MCD1401-979.dwg; MCD1401-980.dwg; MCD1401-981.dwg; MCD1401-982.dwg; MCD1401-983.dwg; MCD1401-984.dwg; MCD1401-985.dwg; MCD1401-986.dwg; MCD1401-987.dwg; MCD1401-988.dwg; MCD1401-989.dwg; MCD1401-990.dwg; MCD1401-991.dwg; MCD1401-992.dwg; MCD1401-993.dwg; MCD1401-994.dwg; MCD1401-995.dwg; MCD1401-996.dwg; MCD1401-997.dwg; MCD1401-998.dwg; MCD1401-999.dwg; MCD1401-1000.dwg